

# Without obstacles

- ✓ Wide range of variants
- ✓ Suitable for laboratory and service walls
- ✓ Load capacity
  - Max. load per wall-mounted cabinet: 80 kg each
  - Floor, shelf, roof: 30 kg each

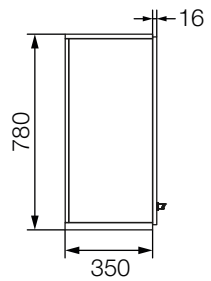

## Wall-mounted cabinets

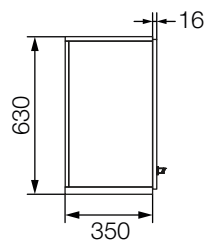
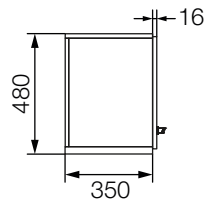

	Width	Height	Carcass depth
Wall-mounted cabinet without doors	450	480 / 630 / 780	350
	600	480 / 630 / 780	350
	900	480 / 630 / 780	350
	1200	480 / 630 / 780	350
	1500	480 / 630 / 780	350
Wall-mounted cabinet with hinged doors	450	480 / 630 / 780	350
	600	480 / 630 / 780	350
	900	480 / 630 / 780	350
	1200	480 / 630 / 780	350
	1500	480 / 630 / 780	350
Wall-mounted cabinet with sliding glass doors	900	480 / 630 / 780	350
	1200	480 / 630 / 780	350
	1500	480 / 630 / 780	350
First aid cabinet	450	480 / 630	350
	600	480 / 630	350
Installation cabinet	300	480 / 630 / 780	350

Dimensions [mm]

Overview of wall-mounted cabinets

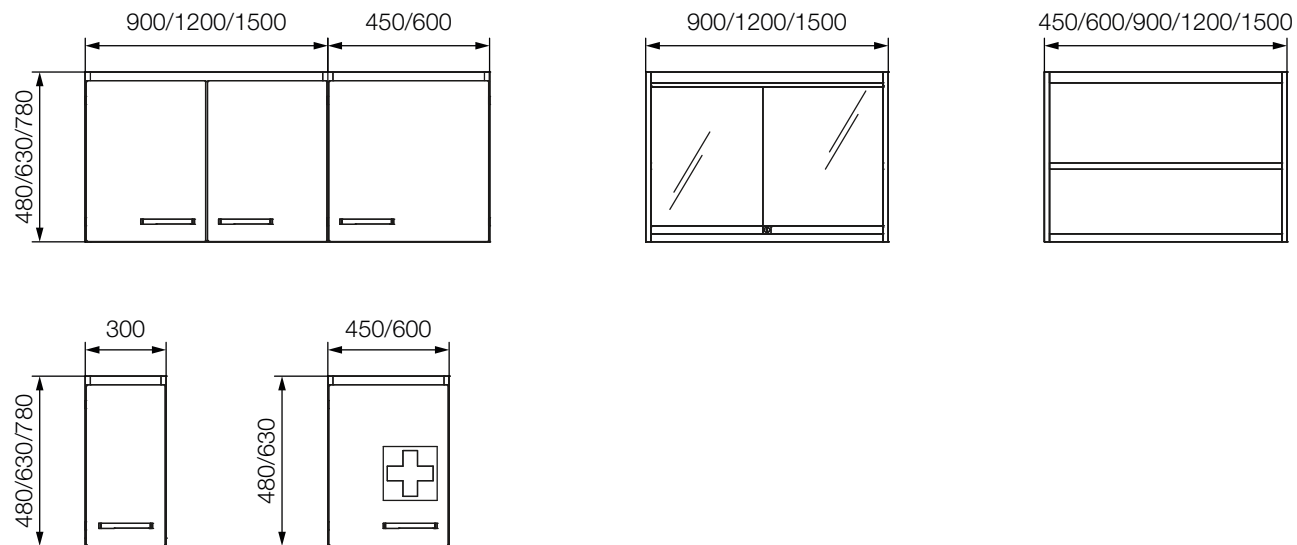

# Optimum use of heights

- ✓ Storage space that leaves room to navigate
- ✓ With practical ladder for top-mounted cabinets
- ✓ Load capacity
  - Max. load per top-mounted cabinet: 80 kg each
  - Floor, shelf, roof: 30 kg each



Top-mounted cabinets

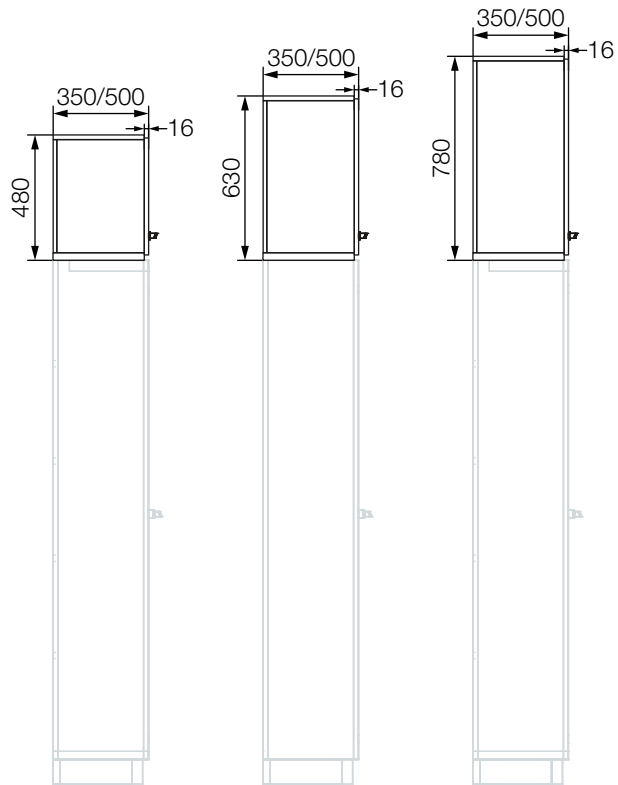

	Width	Height	Carcass depth
Top-mounted cabinet for tall cabinets	600	480 / 630 / 780	350 / 500
	900	480 / 630 / 780	350 / 500
	1200	480 / 630 / 780	350 / 500

Dimensions [mm]

Overview of top-mounted cabinets

